

# STUDIO 4

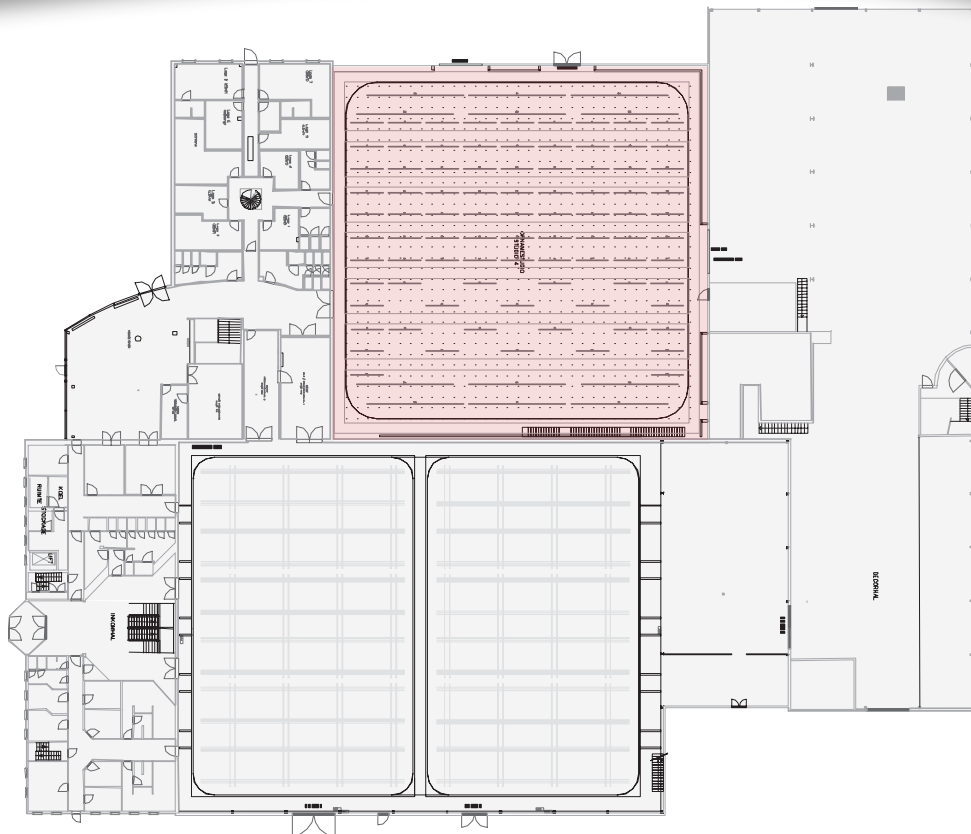

## I. General information:

Name of complex: Studio 100 - Studio 4  
 Address: Nijverheidsstraat 17  
 Postcode: 1840  
 City: Londerzeel  
 Telephone: 03 877 60 35  
 Fax: 03 877 60 36  
 E-mail: Studio100@studio100.be

## TECHNICAL DATA

### 2. Technical data:

#### 2.1 Dimensions:

- Total floor area: 1225 m<sup>2</sup>
  - Length: 35 m
  - Width: 35 m
  - Ceiling height: 14,65 m
- Free floor area: 992 m<sup>2</sup> (Inside cyclo)
  - Length: 31,5 m
  - Width: 31,5 m
  - Ceiling height: 14,65 m
- Clearance: 9,75 m

#### 2.2 Access doors:

- 2 x 2,34 m (W) (Double emergency doors)
- 2 x 0,93 m (W) (Single emergency doors)

#### 2.3 Grid:

- 87 lighting bridges of 300 cm with 3 circuits (Load-bearing capacity: 125 kg)
  - 12 lighting bridges of 900 cm with 3 circuits
- All circuits in the studio are connected with Harting connectors in the dimmer room. All connectors in the dimmer room are Harting 16 pin.  
 Note: Power supply is foreseen in the dimmer room. No fix dimmers available.

#### 2.4 Floor type:

- Polybeton

#### 2.5 Loading dock:

- Loading platform height relative to ground: 0 m
- Access doors:
  - To studio: 5,80 m (H) x 4 m (W)
  - To dressing rooms: 1 m (W) x 2 m (H)

#### 2.6 Power supply:

- Total of 1000 kVA, subdivided into:

Number	Amperes/phase	Connector	Location
1	250 A	Camlock	Studio
1	125 A	CEE	Studio
2	63 A	CEE	Studio
8	32 A	CEE	Studio
3	250 A	Powerlock	Dimmer room

Note: The dimmer room has power supply, but is not equipped with fixed dimmer consoles.

### 3. Building facilities

- Dressing rooms: 6 units (8 m<sup>2</sup>)
  - Mirror
  - Dresser
  - Chair
- Luxury dressing rooms: 2 units (20 m<sup>2</sup> + 5 m<sup>2</sup> (Toilets))
  - Mirror
  - Dresser
  - Chair
  - Shower + washbasin
- Other dressing rooms:
  - Make-up room: - 17 m<sup>2</sup>
    - Mirrors with lighting
    - Work surface
    - Washbasin with hot and cold water

### 4. Curtains

- Colour: Black + White
- Curtain track: 60 running meters

### 5. General arrangements

- No smoking allowed in the studio
- Vehicles are not allowed to be parked in the studio

